

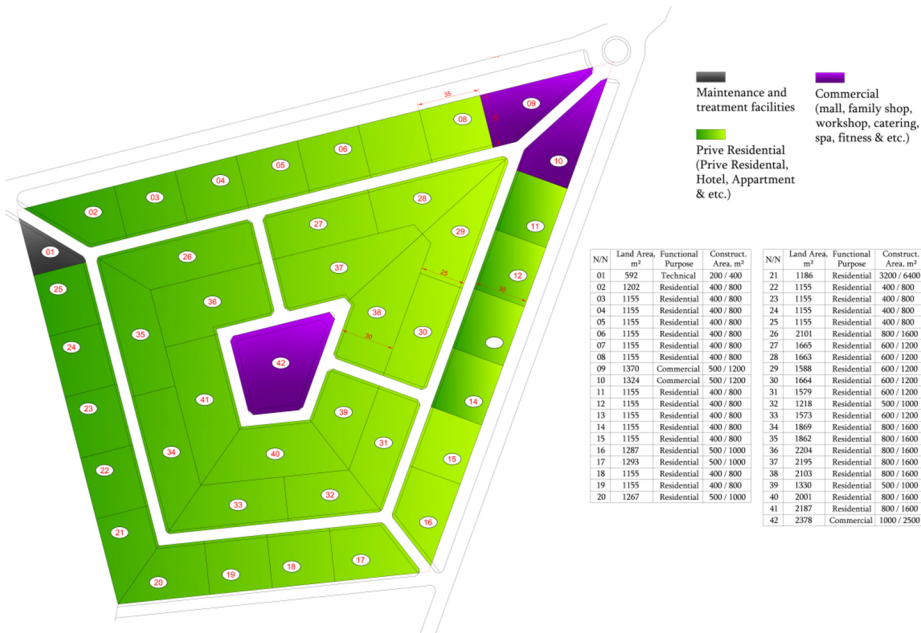

PYRAMID RESIDENTIAL



N/N	Land Area, m ²	Functional Purpose	Construct. Area, m ²	N/N	Land Area, m ²	Functional Purpose	Construct. Area, m ²
01	592	Technical	200 / 400	21	1186	Residential	3200 / 6400
02	1202	Residential	400 / 800	22	1155	Residential	400 / 800
03	1155	Residential	400 / 800	23	1155	Residential	400 / 800
04	1155	Residential	400 / 800	24	1155	Residential	400 / 800
05	1155	Residential	400 / 800	25	1155	Residential	400 / 800
06	1155	Residential	400 / 800	26	2101	Residential	800 / 1600
07	1155	Residential	400 / 800	27	1665	Residential	600 / 1200
08	1155	Residential	400 / 800	28	1663	Residential	600 / 1200
09	1370	Commercial	500 / 1200	29	1588	Residential	600 / 1200
10	1324	Commercial	500 / 1200	30	1664	Residential	600 / 1200
11	1155	Residential	400 / 800	31	1579	Residential	600 / 1200
12	1155	Residential	400 / 800	32	1218	Residential	500 / 1000
13	1155	Residential	400 / 800	33	1573	Residential	600 / 1200
14	1155	Residential	400 / 800	34	1869	Residential	800 / 1600
15	1155	Residential	400 / 800	35	1862	Residential	800 / 1600
16	1287	Residential	500 / 1000	36	2204	Residential	800 / 1600
17	1293	Residential	500 / 1000	37	2195	Residential	800 / 1600
18	1155	Residential	400 / 800	38	2103	Residential	800 / 1600
19	1155	Residential	400 / 800	39	1330	Residential	500 / 1000
20	1267	Residential	500 / 1000	40	2001	Residential	800 / 1600
				41	2187	Residential	800 / 1600
				42	2378	Commercial	1000 / 2500

Project	Unit Name	Total Area	Price Per Meter	Total Price
Pyramid	8	1050	30	31,500
Pyramid	13	1050	30	31,500
Pyramid	21	1079	30	32,370